

Heavy Duty Pop-Out Wall Mount

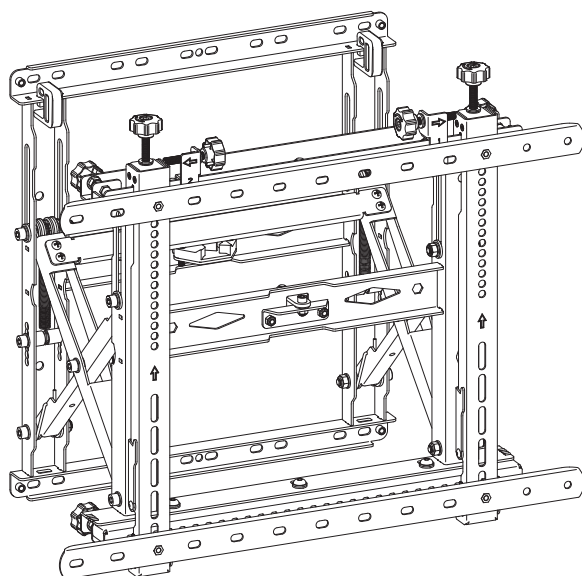

WARNING - RISK OF INJURY

SPRING LOADED MECHANISM

Hold the mount closed when releasing zip ties

Read all instructions before unpacking or assembling

COMPONENT CHECKLIST

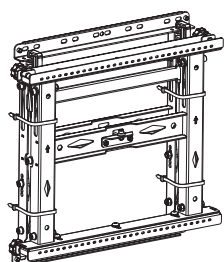

A
Wall Mount
Assembly
(x1)

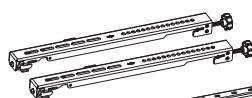

B
Display
Bracket
(x2)

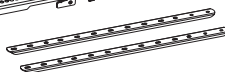

C
600mm
VESA Adaptor
(x2)



D
Right
Lateral
Adjuster
(x1)



E
Left
Lateral
Adjuster
(x1)



F
M6x10
Screw
(x4)



G
6mm
Hex Key
(x1)



M-A
M6x14
Screw
(x4)



M-B
M8x16
Screw
(x4)



M-C
M6x30
Screw
(x4)



M-D
M8x35
Screw
(x4)



M-E
M8
Washer
(x4)



M-F
5mm
Spacer
(x4)



M-G
15mm
Spacer
(x4)

NOTE:

- ! Wall Plate Mounting Fasteners are NOT supplied with Wall Mounts
- ! Professional installer to ensure correct Mounting Fastener type, location & quantity to suit structure where Wall Mount is installed.
- ! ALWAYS use a washer between the chosen fastener and the wall plate.
- ! Mounting fasteners to be used as per manufacturers instructions, including minimum engagement to achieve necessary performance.

Wall

REQUIRED TOOLS

- Phillips head screwdriver
- Power drill
- Suitable drill bit
- Driver bit for selected wall fasteners
- Stud finder
- Spirit level

WEIGHT RANGE

0 - 70kg
(0 - 154lb)

IMPORTANT INFORMATION

- ! Please ensure this product is installed as per these installation instructions.
- ! The manufacturer accepts no responsibility for incorrect installation.
- ! Failure to mount this product correctly may cause serious injury/death during or following installation.
- ! This product is not suitable for outdoor use.
- ! Do not use this product for mobile applications.
- ! Wall mount only achieves maximum weight rating when appropriately fastened to a wall of adequate structural capacity.
- ! Professional installer to ensure adequate structural capacity of wall (including appropriate safety factor) to support total weight of all equipment being mounted.
- ! Drilling into electrical wires can cause death - use appropriate equipment and caution when drilling holes in walls to avoid electrical cables, water pipes and gas pipes. Do not drill into structures unless you have established it's safe to do so.

1. Safely unpack the Wall Mount Assembly

WARNING - RISK OF INJURY

This mount features a spring-loaded mechanism.

Improperly releasing zip ties could result in the mount unintentionally opening with force, causing injury.

- 1.1.** Rest the Wall Mount Assembly **A** on a flat surface
- 1.2.** Firmly hold the mount closed
- 1.3.** Release the zip ties using scissors (not included)

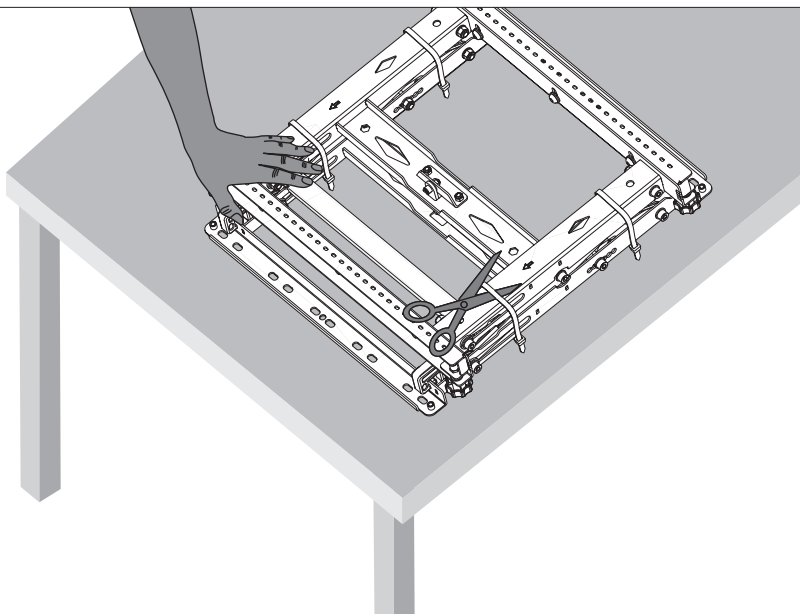

2. Mount the Wall Mount Assembly to the wall

NOTE:

- Choice and supply of appropriate wall plate fasteners is the responsibility of the installer.
- Consult a preferred fastener supplier or a structural engineer to select fasteners which are most appropriate for the weight of the display and wall construction method.
- Wall mount assembly must be level. Verify using a quality spirit level tool.
- On a Stud Wall or Drywall use a good quality stud finder to position mounting fasteners in the centre of studs.
- On a Masonry Wall avoid positioning Wall Mount Assembly mounting fasteners in a mortar joint.

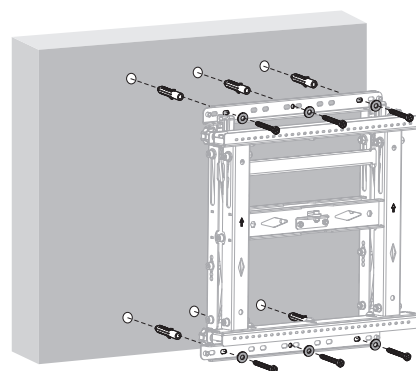
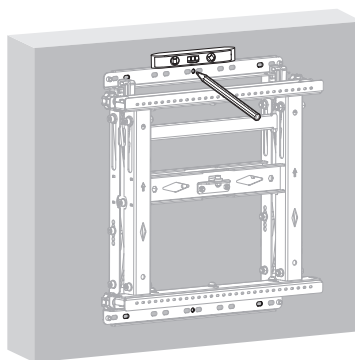
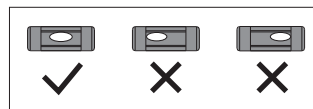
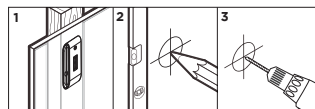

*Fasteners shown are for example only

A - FOR DISPLAYS WITH VESA SPACING 400x400 OR SMALLER

A3. Attach the Display Brackets to the Display

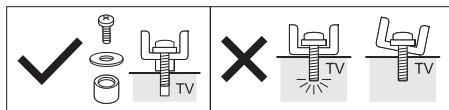

NOTE:

- Always use washers **M-E**
- Ensure the display brackets are not loose and screws are not forced too deep into the display
- If spacers **M-F** & **M-G** are needed, use the shortest possible combination between the display bracket and the display

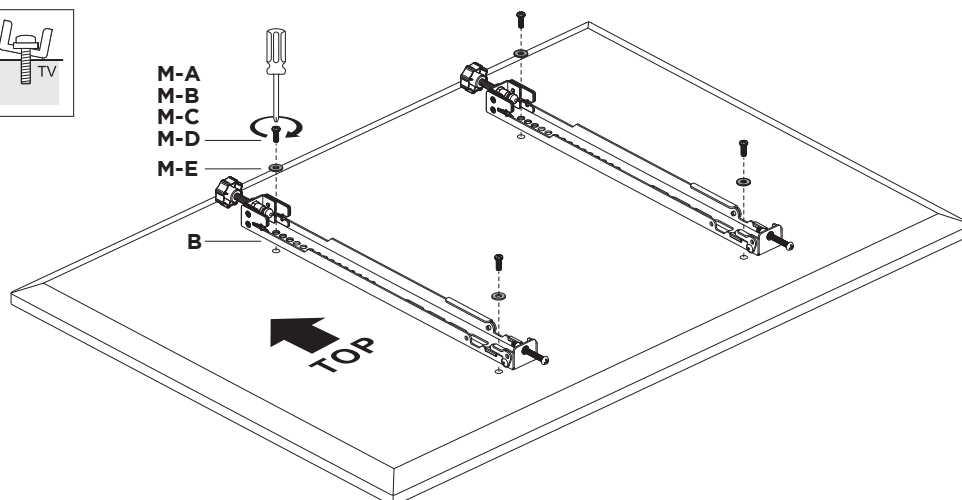

B - FOR LANDSCAPE DISPLAYS WITH VESA SPACING UP TO 600x400

B3. Attach the Display Brackets to the Display

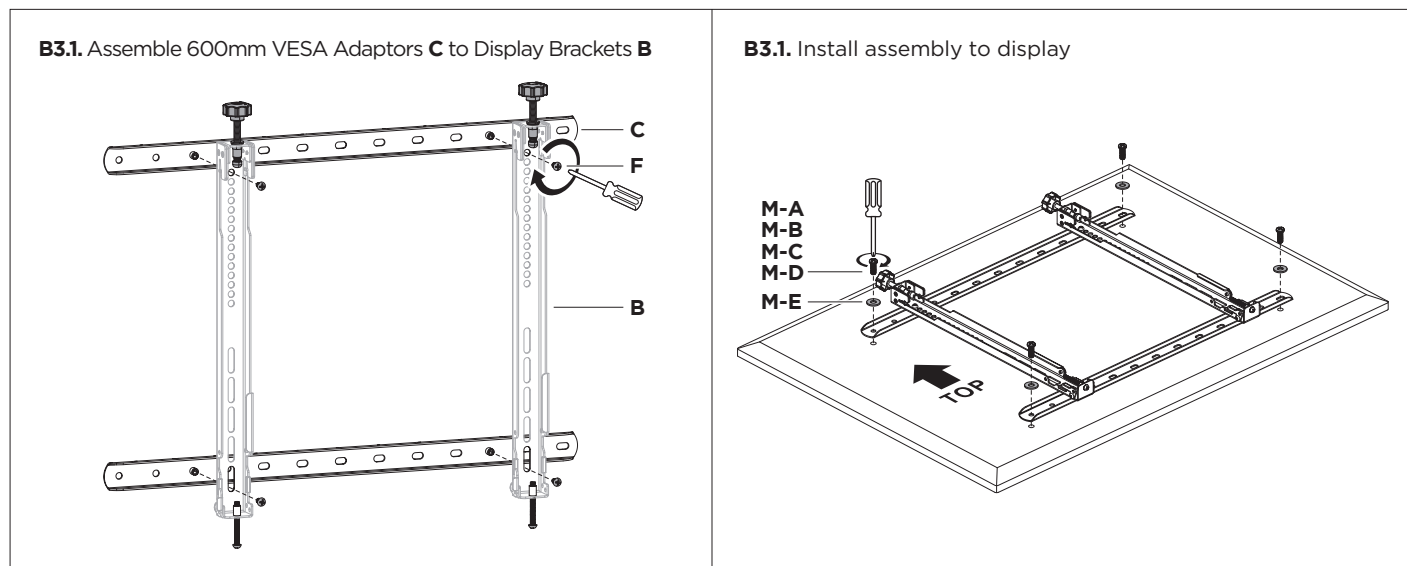

C - FOR PORTRAIT DISPLAYS WITH VESA SPACING UP TO 400x600

C3. Attach the Display Brackets to the Display

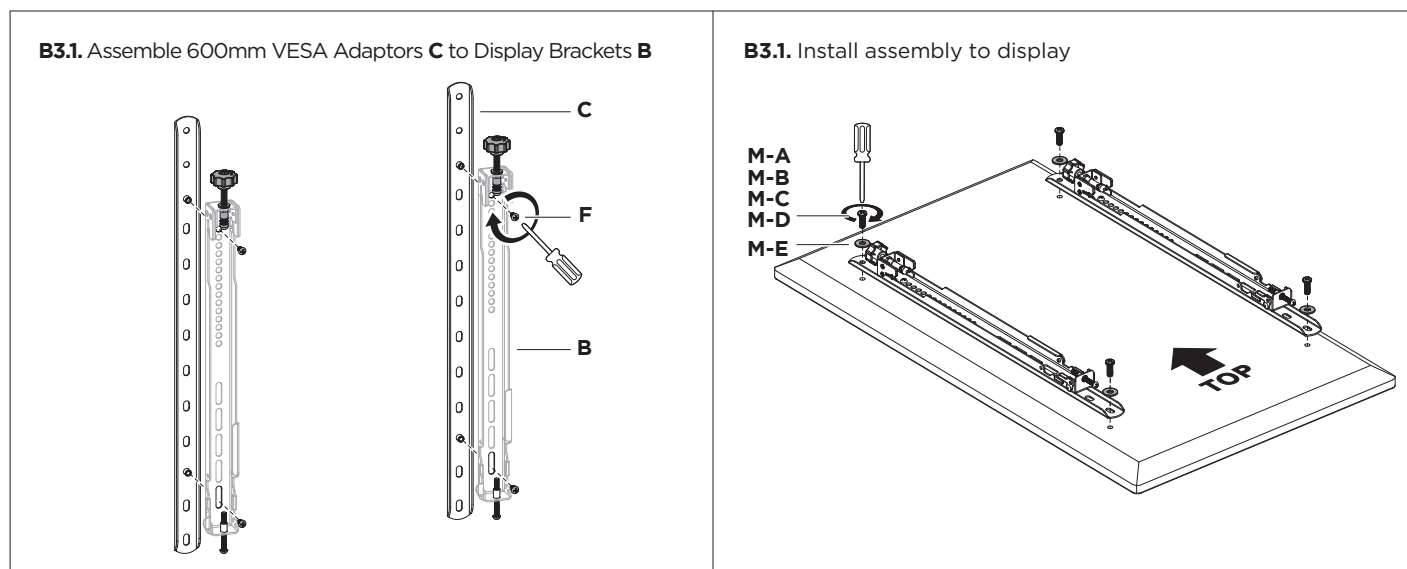

4. Hook and Secure Display onto the Wall Mount Assembly

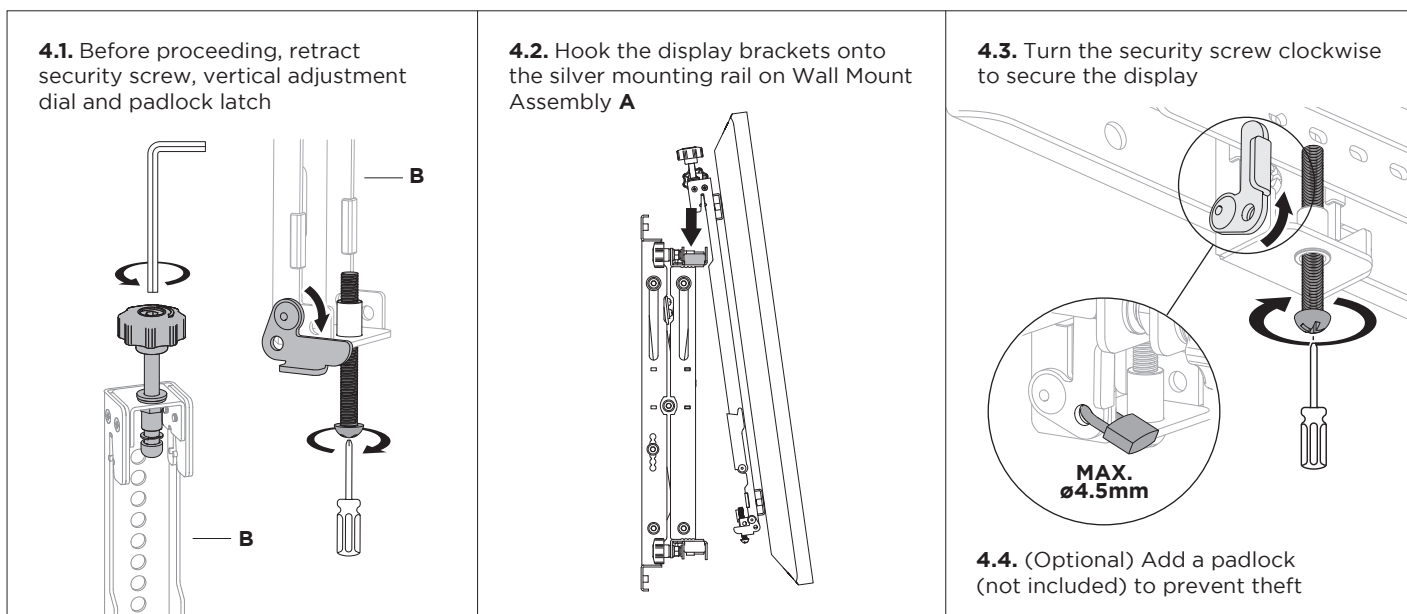

5. (Optional) Install Lateral Shift Adjusters

5.1. Align the tabs on Right Lateral Adjuster **D** to the slots on the silver mounting rail closest to the right Display Bracket **B**

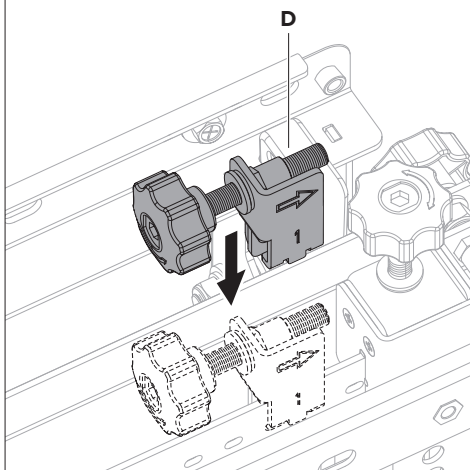

5.2. Align the tabs on Left Lateral Adjuster **E** to the slots on the silver mounting rail closest to the left Display Bracket **B**

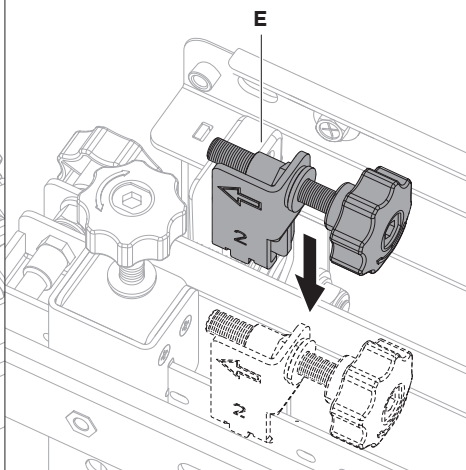

5.3. Turn the thumbscrew on the rear of each adjuster clockwise to secure

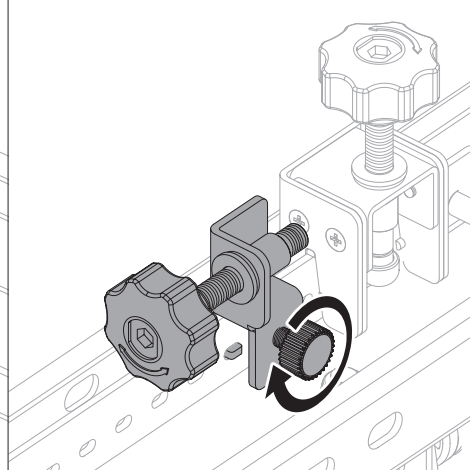

6. Service the display

6.1. Check if pop-out locks are installed, raise and remove before proceeding.

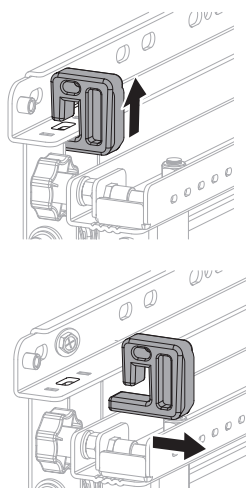

6.2. Pop-out the display by applying firm but gentle pressure to the bezels of the display until the limit is reached. Then, to prevent damage to the display, gently remove pressure and guide the display away from the wall. Repeat to pop the display back in place.

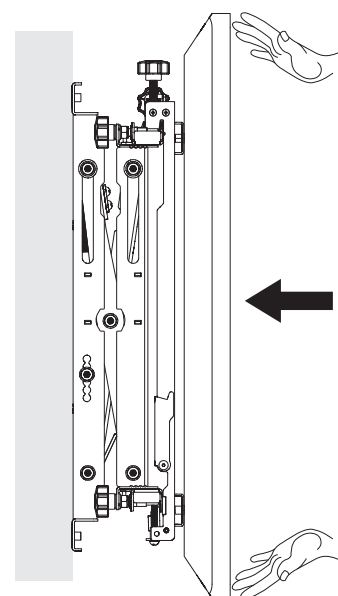

6.3. (Optional) To use kickstands, first - retract the security screw and padlock latch on each Display Bracket **B**. Carefully tilt the display up and rotate the kickstand back to rest on Wall Mount Assembly **A**. Perform steps in reverse when service is complete.

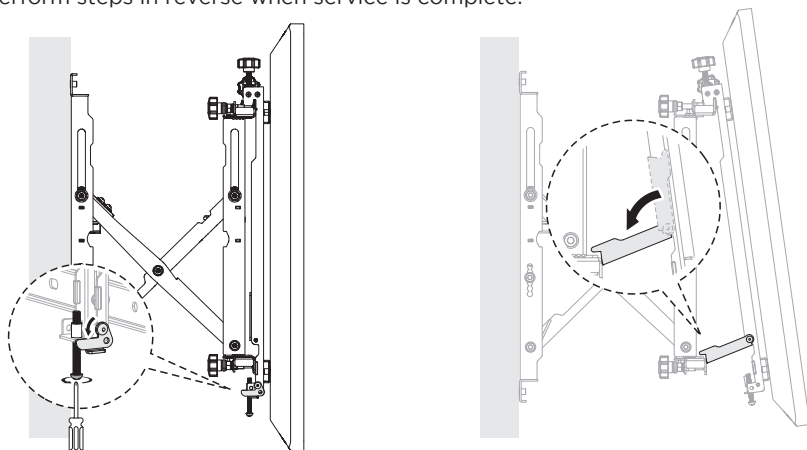

6.4 (Optional) To prevent tampering, lower each pop-out lock into each slot. This will disable the pop-out mechanism.

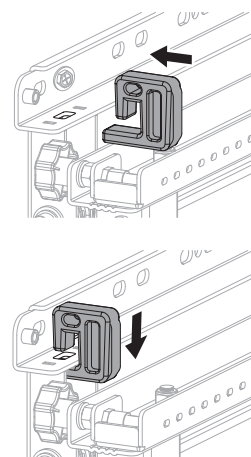

7. (Optional) Install a multi-display array

7.1. To install a multi-display array, space each column approx. 1 display apart.

Space each row approx 1 display + 3mm (1/8") apart to allow for adjustment.

X = Width of Display

Y = Height of Display

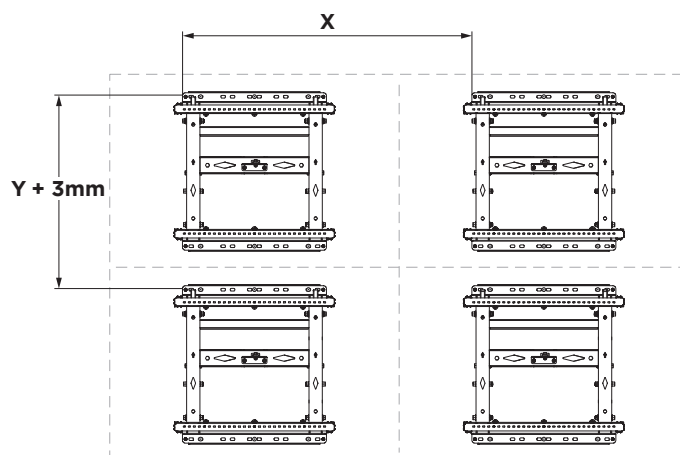

7.2. To adjust multi-display arrays, start with the display in the bottom left corner.

Adjust each row left to right, then proceed to adjust the row above in the same manner.

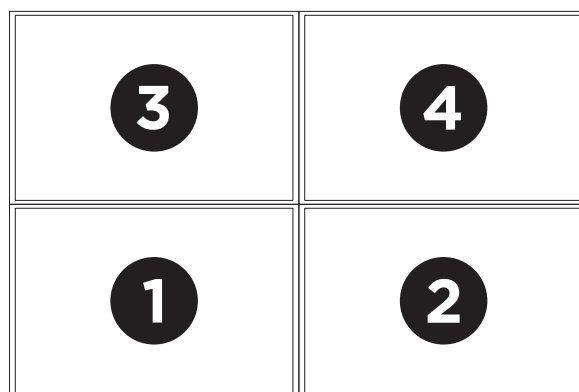

7.3. Ensure a minimum 1mm gap is left between each side of each display.

Ensure that displays are not “resting” on one another.

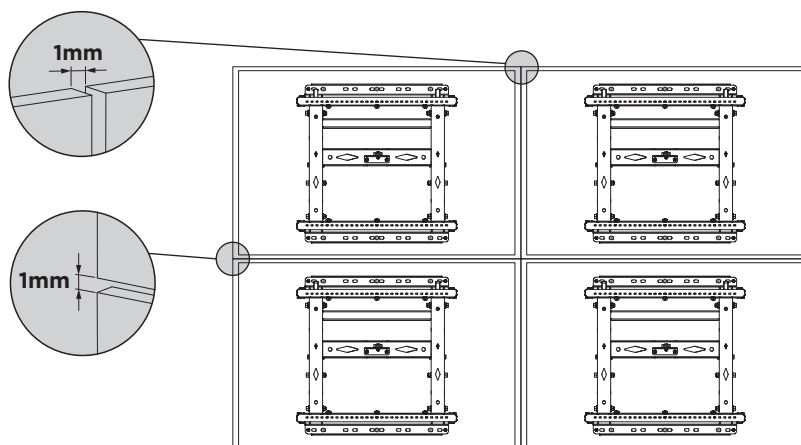

ADJUSTMENTS

Lateral adjustment

+/-15mm (0.59")
with 400mm or wider VESA



Vertical (level) adjustment

13mm (0.51")

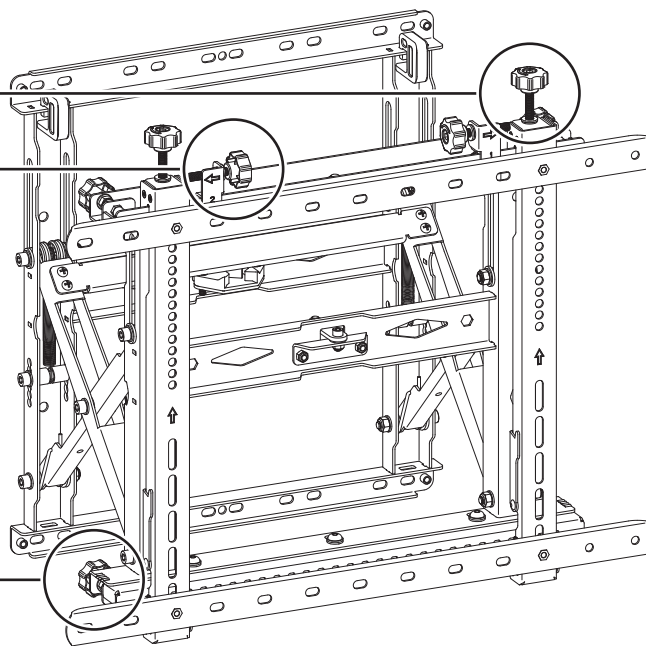
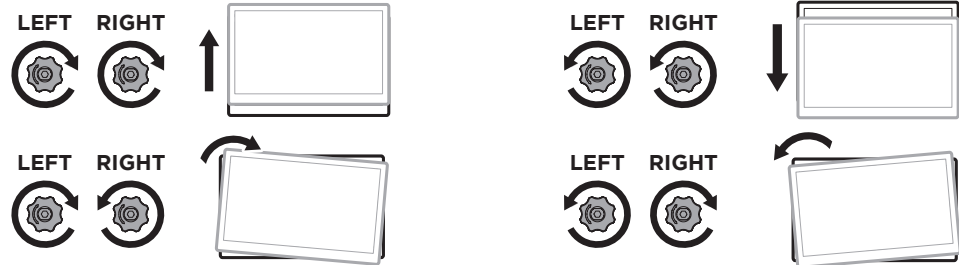

Depth (tilt/pan) adjustment

13mm (0.51")
+2/-3°

